

Solder Mount Receptacle (Hermetic)

T9 Series • Advanced Military & Aerospace Connectors



Smallest receptacle for sensors or probes

The hermetic solder mount receptacle is designed to have the smallest mounting footprint available. The reduced flange is useful when soldering in high densities to a panel or mounting to compact probes or sensors. The low-profile rear design does not permit the use of a backshell.

T919 HA 11-99 P N - 02

- 1 **BASIC PART NUMBER**
T919 Hermetic solder mount receptacle
 Helium leakage <math> < 1.0 \times 10^{-6}</math> cc³/sec at 15 psi (1.1 kg/cm²). Insert rated to 14,000 psi (984 kg/cm²) when precision welded or soldered.
- 2 **MATERIAL & FINISH**
HA Stainless steel, passivated
HB Stainless steel, electrodeposited nickel
- 3 **SHELL SIZE & INSERT ARRANGEMENT**
 See Insert Arrangement Selection table, p. F-19 (Verify hermetic availability on table)
- 4 **CONTACT STYLE**
P Pin only, gold plated
H* Socket, gold plated
(PC tail contacts available, contact your authorized distributor)
- 5 **ALTERNATE KEYING**
N NORMAL or A, B, C, D, E
- 6 **OPTIONAL ACCESSORY KIT (OMIT FOR NONE)**
02 Protective cover

* Please consult an authorized distributor for lead time and minimum quantity requirements.

Receptacle Dimensions

Shell Size	Military Shell Size	D	C Thread Class 2A	L	F	T	E	U	P Max Rear Panel†	H Front Mount	E Rear Mount
9	A	.750 (19.1)	.6250-0.1P-0.3L-TS	.806 (20.5)	.031 (0.8)	.125 (3.2)	.375 (9.5)	.672 (17.1)	.234 (5.9)	.702 (17.8)	.650 (16.5)
11	B	.844 (21.4)	.7500-0.1P-0.3L-TS	.806 (20.5)	.031 (0.8)	.125 (3.2)	.375 (9.5)	.781 (19.8)	.234 (5.9)	.811 (20.6)	.800 (20.3)
13	C	.969 (24.6)	.8750-0.1P-0.3L-TS	.806 (20.5)	.031 (0.8)	.125 (3.2)	.375 (9.5)	.906 (23.0)	.234 (5.9)	.936 (23.8)	.910 (23.1)
15	D	1.094 (27.8)	1.0000-0.1P-0.3L-TS	.806 (20.5)	.031 (0.8)	.125 (3.2)	.375 (9.5)	1.031 (26.2)	.234 (5.9)	1.061 (27.0)	1.040 (26.4)
17	E	1.218 (30.9)	1.1875-0.1P-0.3L-TS	.806 (20.5)	.031 (0.8)	.125 (3.2)	.375 (9.5)	1.156 (29.4)	.234 (5.9)	1.186 (30.1)	1.210 (30.7)
19	F	1.312 (33.3)	1.2500-0.1P-0.3L-TS	.806 (20.5)	.031 (0.8)	.125 (3.2)	.375 (9.5)	1.250 (31.8)	.234 (5.9)	1.280 (32.5)	1.280 (32.5)
21	G	1.438 (36.5)	1.3750-0.1P-0.3L-TS	.806 (20.5)	.031 (0.8)	.125 (3.2)	.375 (9.5)	1.375 (34.9)	.234 (5.9)	1.405 (35.7)	1.410 (35.8)
23	H	1.563 (39.7)	1.5000-0.1P-0.3L-TS	.838 (21.3)	.031 (0.8)	.156 (4.0)	.375 (9.5)	1.500 (38.1)	.234 (5.9)	1.530 (38.9)	1.530 (38.9)
25	J	1.688 (42.9)	1.6250-0.1P-0.3L-TS	.838 (21.3)	.031 (0.8)	.156 (4.0)	.375 (9.5)	1.625 (41.3)	.234 (5.9)	1.655 (42.0)	1.660 (42.2)

Dimensions are in inches (mm). † Max panel thickness applies only to rear mount applications to ensure proper coupling clearance.

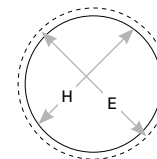
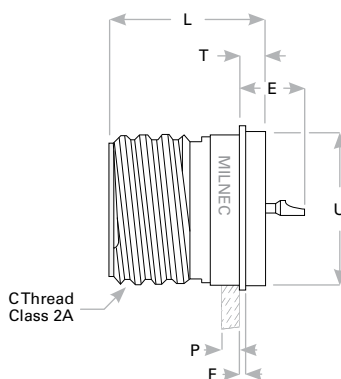
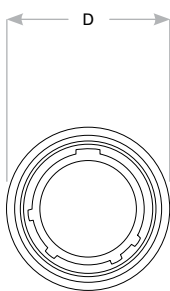

Panel Cutout

Rev. 1239.1